

# RATIO 圆融

Design by Ximi Li 李希米



## 产品描述

主体为木制开孔漆，桌面为岩板，抽屉底部为黑镜镀钛金属。

## PRODUCT DESCRIPTION

Side panel and drawers are made of wood, top made of sintered stone, bottom decorated with black color titanium rail.

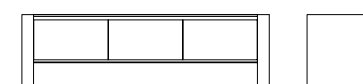

2398\*500\*550MM  
94.4\*19.7\*21.7"

2098\*500\*550MM  
82.6\*19.7\*21.7"

1798\*500\*550MM  
70.8\*19.7\*21.7"

编号：52C011

圆与面相交错而生，碰撞出新的切面。木与石，与金属，个性各不同的材质家族融合出1+1大于2的表现力。RATIO圆融台面的石材与实木拼接打破常规带来更多细节，全系列以半圆立柱装饰，突破横平竖直的传统形式，再加以金属提亮点缀。让人惊喜的发现，相似不一定相融，不同却和谐的相交更具魅力。

The substantial semi-cylinder legs joint the slim stone top, the RATIO cabinet collection is both sturdy and elegant. Feathering multiple materials that adds details and highlight to this piece.